



PERSONAL
COMPUTERS



SMALL
COMPUTERS
NETWORK

Net Dialog

800-2000 VA single-phase

Net Dialog 800-2000 VA



The **NET DIALOG** series includes the 800-1000-1500-2000 VA models and uses digital technology. The load is powered from the mains through an AVR to stabilise brownout, sag and surge voltages, and EMI filters to suppress spikes and transients.

When the mains fails, the load is powered by the inverter with a pseudo sine wave to provide sufficient runtime for computer system shutdown using the **PowerShield³** software supplied as standard.

The UPS also incorporates a filtered socket for PC network and telephone line cable protection.

For advanced communication and top flight performance, **NET DIALOG** is the ideal solution for small network users requiring total control of their power system.

CHARACTERISTICS

- Mains power supply stabilisation and filtering (technology with AVR and filters for atmospheric disturbance suppression)
- Cold Start capability: the UPS can power up without a mains supply present

- Auto restart at power-up
- Integrated protection for PC networks and telephone line/modem connections RJ11/45
- High reliability with built-in automatic battery test feature

ADVANCED COMMUNICATION

- Advanced, multi-platform communication for all operating systems and network environments: PowerShield³ monitoring and shut-down software included, for Windows 2008, Vista, 2003, XP; Mac OS X, Linux, Novell and most popular Unix operating systems.
- The UPS is supplied with a communications cable for Plug and Play PC connection

2 YEAR WARRANTY

MODELS	ND 80	ND 100	ND 150	ND 200
POWER	800VA/480W	1000VA/600W	1500VA/900W	2000VA/1200W
INPUT				
Rated voltage	220-230-240 Vac			
Voltage range	230 Vac ($\pm 25\%$)			
Frequency	50/60 Hz auto sensing			
OUTPUT				
Voltage on mains operation	230 Vac (-8%, +10%)			
Voltage on battery operation	230 Vac (+/- 5%)			
Frequency on battery operation	50 or 60 Hz (+/- 0.5%)			
Transfer time	2 ms			
Waveform from battery/inverter	Pseudo sinewave			
BATTERIES				
Type	VRLA AGM Maintenance-free lead-acid			
Recharge time	4-6 h			
ENVIRONMENTAL				
Weight (kg)	14	14.5	15	20
Dimensions (HxWxD) (mm)	180 x 140 x 375			214 x 140 x 410
Protection	Battery low - overcurrent - short-circuit			
Tel/Modem protection	RJ11/45 connectors			
Communication	RS232 port			
Compliance	EN 62040-1-1 and Directive 2006/95/EC; EN 62040-3 EN 62040-2 and Directive 2004/108 EC			
Surge capability	IEC 801-5			
Operating temperature	0°C ÷ +40°C			
Storage temperature	-15°C ÷ +45°C			
Relative humidity	< 95% non condensing			
Noise	< 40 dBA at 1 m			
Colour	Dark grey RAL 7016			

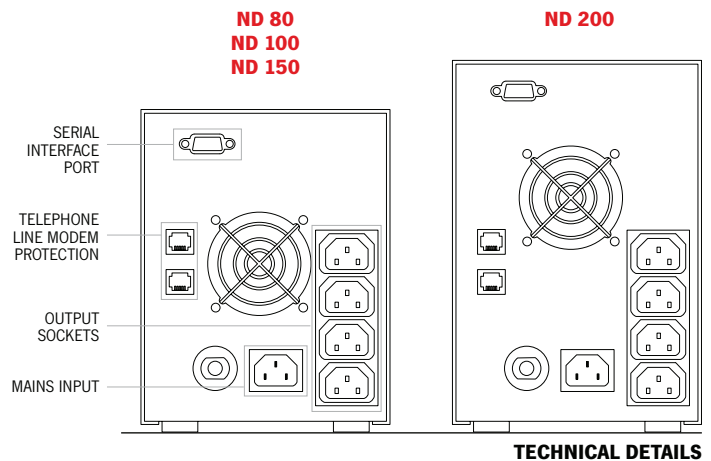

TECHNICAL DETAILS